



Per-Diem and Travel Nurses Parking Options

Per-Diem and Travel Nurses are eligible to receive a free Park & Ride Permit.

This permit is an adhesive sticker that is placed on the right hand side (passenger side) of the windshield of your vehicle.



This permit will allow you to use any of the Park and Ride lots Monday- Friday on the Day Shift.

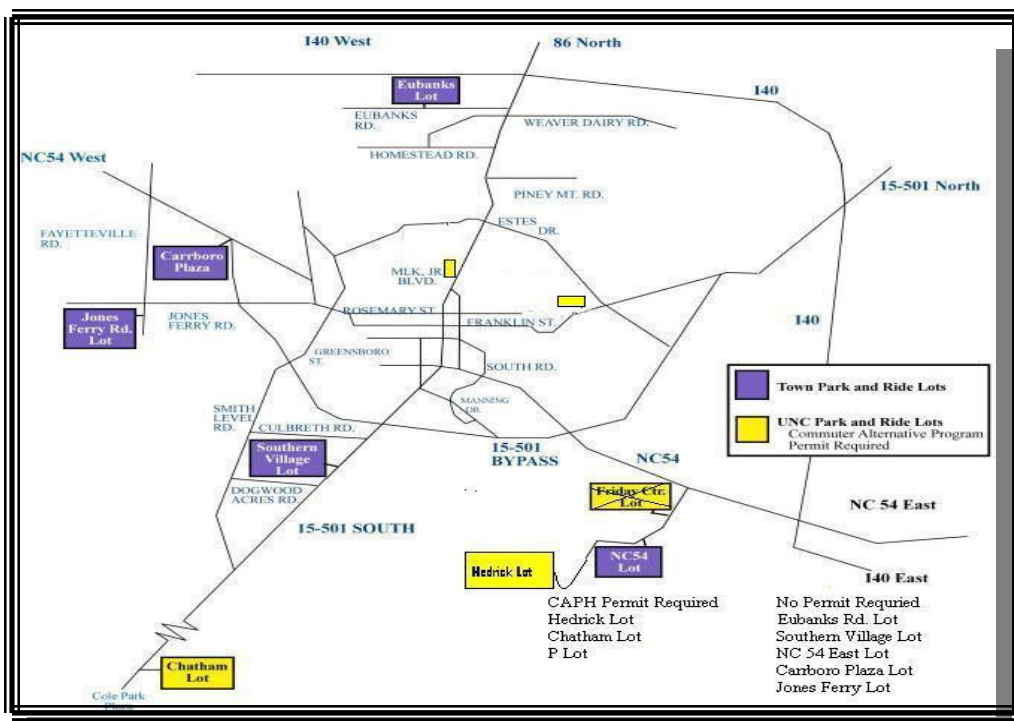

This same permit will allow parking in the Dogwood Visitors Deck week nights after 5:00 P.M. or at any time on Saturday and Sunday with a gate access card.

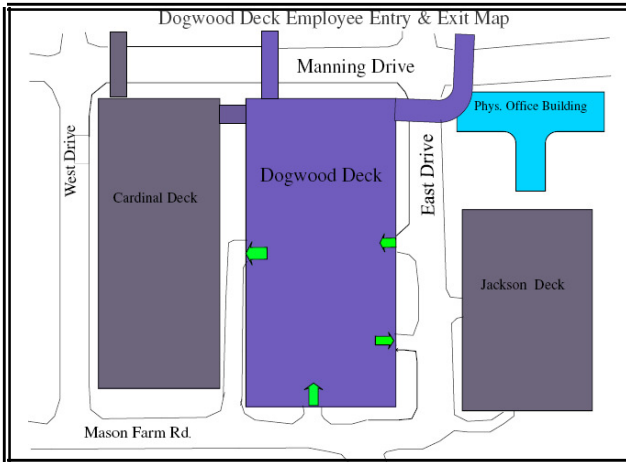

If you work the afternoon shifts there is Chapel Hill Transit Bus service to the Hedrick Building Park & Ride lot until 10:10 P.M. on week nights. Also there are late night shuttle available from the “Kiss and Go Lane” in front of N.C. Memorial Hospital along the East Drive exit as late as 11:40 P.M.

**Late Night Shuttle to
Southern Village/
Chatham Crossing Park
& Ride Lot**

*Shuttle Leaves From the
Kiss & Go Lane in Front
of the
NC Memorial Hospital.*

**Southern Village/
Chatham Departure:**

- 8:10 P.M.
- 8:40 P.M.
- 9:10 P.M.
- 9:40 P.M.
- 10:10 P.M.
- 10:40 P.M.
- 11:10 P.M.
- 11:40 P.M.



Above: Kiss & Go Lane at N.C. Memorial Exit.

Left: Late Night Shuttle Times

Rams Head Parking Deck



The Rams Head Deck

Employees may park in the Rams Head Deck on campus. The Rams Head Deck is located off of Ridge Road beside Kenan Stadium. A parking attendant or automated pay station is on duty to receive payment for parking 24 hours a day, seven days a week unless otherwise posted. Student commuter permits for the deck are valid Monday - Friday 7:00 a.m. until 6:00 p.m. Students lacking the appropriate permit and any employee may park in the Rams Head and pay the hourly rate. The hourly parking fee is \$1.25 per hour with a \$30 daily maximum and reservations are \$6.00 per half day (4 hours) and \$12 per full day (8 hours). The lost ticket fee for this facility is \$24 and no vehicle can park for more than a 24 hour period in the deck without exiting and paying the required fee. During holidays when the attendant is not on duty, the parking gates will be open, and there will be no charge for parking in the deck. There is not charge for visits of less than five minutes.